

TİP 52

FORM	DxL	SxLF	Kalite	LO			
				Quality	10	15	20
H			Qualität				
H-1	8	6x40	EKR 60 P5V	86000	78000	78000	66000
H-2	10	6x40	EKR 60 P5V	86000	78000	71000	66000
H-3	12	6x40	EKR 60 P5V	71000	66000	62000	60000
H-4	15	6x40	EKR 46 P5V	53000	53000	53000	51000
H-5	20	6x40	EKR 46 P5V	34000	30000	25000	22000
H-6	25	6x40	EKR 46 P5V	34000	30000	25000	22000
H-7	30	6x40	EKR 46 P5V	20000	17000	14000	13000
H-8	32	6x40	EKR 46 P5V	19000	16000	13000	12000

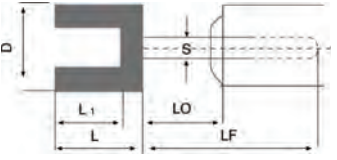

TİP 52

FORM	DxL	SxLF	Kalite	LO			
				Quality	10	15	20
G			Qualität				
G-1	20x16	6x40	EKR 60 P5V	43000	43000	41000	37000
	12x20						
G-2	25x20	6x40	EKR 60 P5V	34000	34000	30000	27000
	15x12						
G-3	32x25	6x40	EKR 60 P5V	24000	22000	18000	16000
	20x15						
G-4	40x32	6x40	EKR 46 P5V	19000	16000	13000	12000
	24x20						

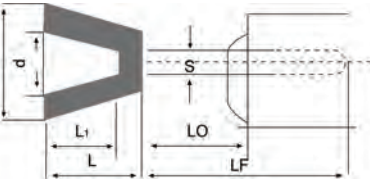

TİP 52

FORM	DxL	SxLF	Kalite	LO			
				Quality	10	15	20
K			Qualität				
K-1	20x16	6x40	EKR 60 P5V	43000	43000	41000	37000
	12x20						
K-2	25x20	6x40	EKR 60 P5V	34000	34000	30000	27000
	15x12						
K-3	32x25	6x40	EKR 60 P5V	24000	22000	18000	16000
	20x15						
K-4	40x32	6x40	EKR 46 P5V	19000	16000	13000	12000
	24x20						

Saplı Taşlar

Yaklaşık çeşitli ölçü ve kum cinsinde 2500 standart üretim yapılmaktadır. Saplı taşlar demir, çelik, döküm, cam, mermer gibi malzemelerin taşlanması için kullanılır. Üçer Zimpara'da özel ölçü ve kalitelere göre saplı taş imalatı yapılır. Standart üretimin yanı sıra özel olarak 2.35, 3, 4, 5, 6, 8, 10 Å mm sap ölçülerinde her kalitede üretim yapılmaktadır.

T.S:291/40
D:Çap
L:Yükseklik
S:Mil çapı
LO:Bağlama presine uzaklığı

Mounted Points

Approximately 2500 varieties of standard products of various sizes and grit types are manufactured. Mounted points are used for grinding materials such as iron, steel, cast iron, glass, marble, etc. At Üçer, the mounted points are manufactured in special sizes and grades. In addition to standard production, the mounted points can also be custom-made in shaft sizes of 2.35, 3, 4, 5, 6, 8 and 10 mm according to customers' specific requirements.

T.S:291/40
D:Diameter
L:Height
S:Shaft diameter
LO:Distance of the wheel at connecting tongs

Schleifstifte

Etwa 2500 Arten von Kies in unterschiedlichen Größen und Typen werden hergestellt. Schleifstifte werden für Schleifwerkzeuge aus Eisen, Stahl, Abguss, Glas, Marmor usw. gebraucht. Üçer Schleifscheibe GmbH stellt die Schleifstifte in speziellen Größen und Qualitäten her. Außer der Standardherstellung werden die Schleifstifte speziell in Griffgrößen von 2.35, 3, 4, 5, 6, 8, 10 Å mm und in jeder Art der Qualität produziert.

T.S:291/40
D:Durchmesser
L:Höhe
S:Achsdurchmesser
LO:Abstand der Scheibe an Verbindungszangen

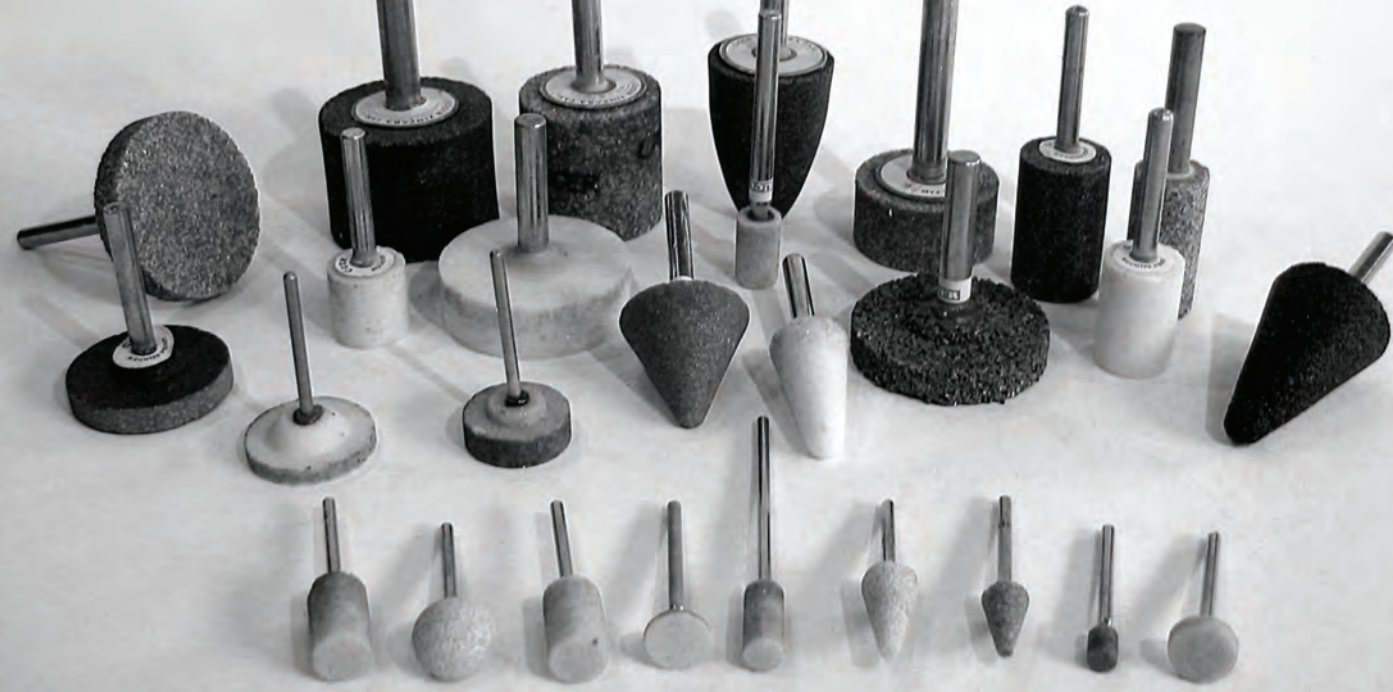

SAPLI TAŞLAR

MOUNTED POINTS

SCHLEIFSTIFTE

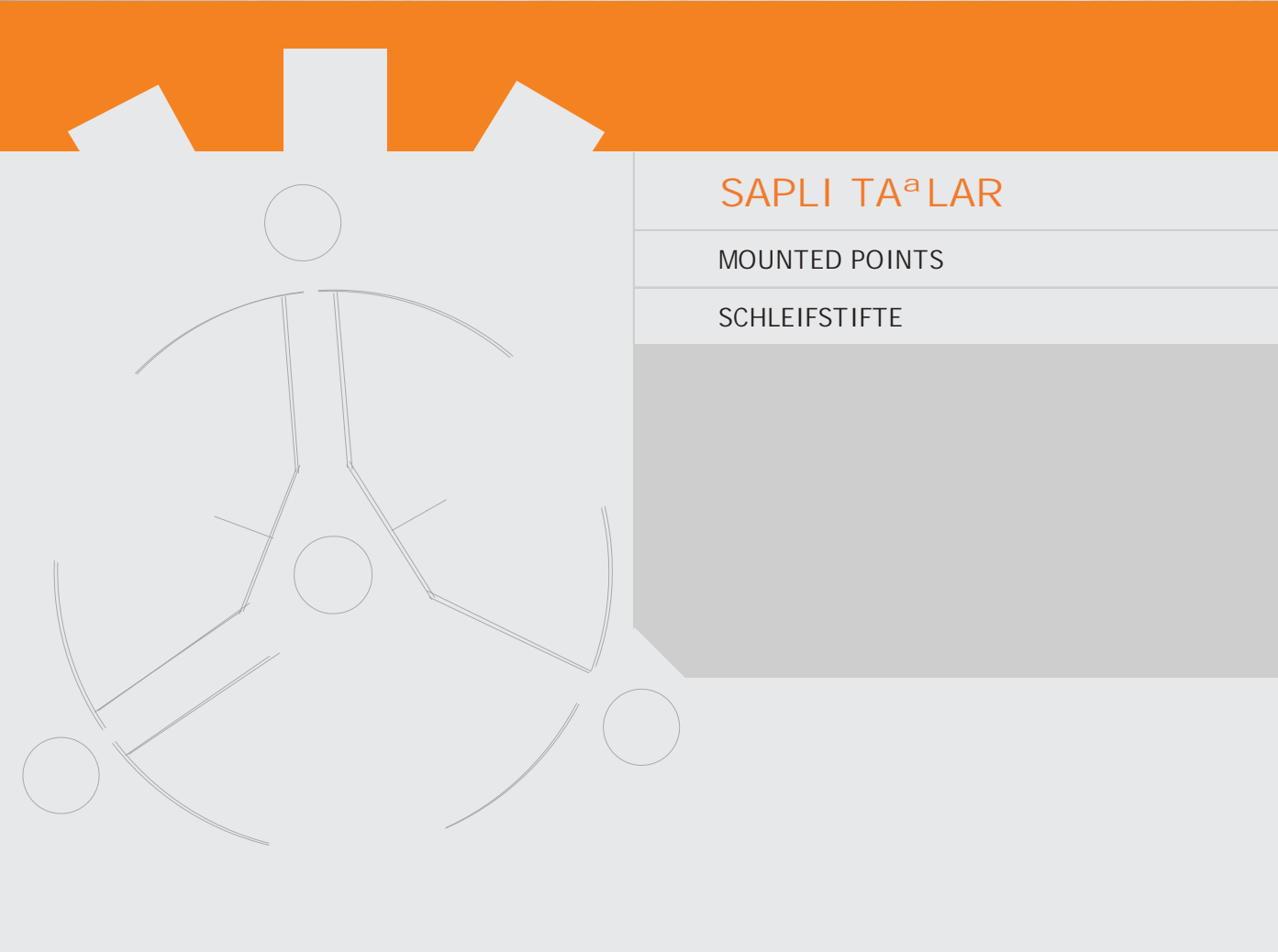

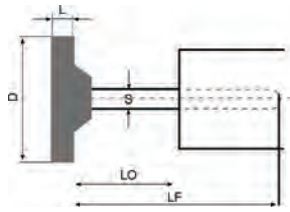

TİP 52

FORM	DxL	SxLF	Kalite	LO				
				Quality	10	15	20	25
A-1	12x4	6x40	EK 60 P5V	53000	53000	53000	53000	
A-2	16x4	6x40	EK 60 P5V	53000	53000	53000	53000	
A-3	16x10	6x40	EK 60 P5V	53000	53000	53000	53000	
A-4	20x4	6x40	EK 60 P5V	43000	53000	53000	53000	
A-5	20x8	6x40	EK 60 P5V	43000	53000	53000	53000	
A-6	20x16	6x40	EK 46 P5V	43000	53000	53000	53000	
A-7	25x4	6x40	EK 60 P5V	34000	34000	34000	34000	
A-8	25x8	6x40	EK 46 P5V	34000	34000	34000	34000	
A-9	25x10	6x40	EK 46 P5V	34000	34000	34000	34000	
A-10	25x20	6x40	EK 46 P5V	34000	34000	34000	34000	
A-11	30x4	6x40	EK 60 P5V	26000	26000	26000	26000	
A-12	30x8	6x40	EK 46 P5V	26000	26000	26000	26000	
A-13	30x16	6x40	EK 46 P5V	26000	26000	26000	26000	
A-14	30x20	6x40	EK 46 P5V	26000	26000	26000	26000	
A-15	40x6	6x40	EK 60 P5V	21000	21000	21000	21000	
A-16	40x10	6x40	EK 46 P5V	21000	21000	21000	21000	
A-17	40x16	6x40	EK 46 P5V	21000	21000	21000	21000	
A-18	40x20	6x40	EK 46 P5V	21000	19000	17000	17000	
A-19	50x10	6x40	EK 46 P5V	17000	17000	17000	17000	
A-20	50x16	6x40	EK 46 P5V	17000	17000	17000	17000	
A-21	50x20	6x40	EK 46 P5V	17000	15000	12000	11000	
A-22	60x16	6x40	EK 46 P5V	14300	12500	9500	9000	
A-23	60x20	6x40	EK 46 P5V	14300	12500	9500	9000	

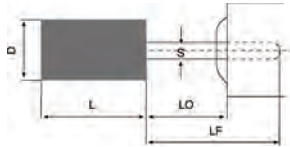

TİP 52

FORM	DxL	SxLF	Kalite	LO				
				Quality	10	15	20	25
B-1	3x8	6x40	EK 80 P5V	80000	66000	56000	50000	
B-2	4x8	6x40	EK 80 P5V	64000	53000	45000	40000	
B-3	5x10	6x40	EK 80 P5V	64000	53000	45000	40000	
B-4	6x12	6x40	EK 60 P5V	53000	44000	37000	33000	
B-5	6x16	6x40	EK 60 P5V	45000	37000	31000	28000	
B-6	8x12	6x40	EK 60 P5V	49000	41000	34000	31000	
B-7	8x16	6x40	EK 60 P5V	38000	32000	27000	24000	
B-8	10x10	6x40	EK 60 P5V	86000	86000	86000	86000	
B-9	10x15	6x40	EK 60 P5V	86000	86000	76000	68000	
B-10	10x20	6x40	EK 60 P5V	86000	75000	63000	57000	
B-11	10x25	6x40	EK 60 P5V	75000	63000	53000	47000	
B-12	12x12	6x40	EK 60 P5V	53000	53000	53000	53000	
B-13	12x20	6x40	EK 60 P5V	53000	53000	53000	53000	
B-14	12x30	6x40	EK 60 P5V	53000	53000	53000	53000	
B-15	16x16	6x40	EK 46 P5V	29000	24000	20000	18000	
B-16	16x20	6x40	EK 46 P5V	53000	53000	46000	41000	
B-17	16x30	6x40	EK 46 P5V	42000	35000	29000	26000	
B-18	16x40	6x40	EK 46 P5V	28000	24000	20000	18000	
B-19	20x20	6x40	EK 46 P5V	43000	43000	36000	32000	
B-20	20x30	6x40	EK 46 P5V	43000	36000	30000	27000	
B-21	20x40	6x40	EK 46 P5V	28000	24000	20000	18000	
B-22	25x25	6x40	EK 46 P5V	34000	30000	25000	22000	
B-23	25x32	6x40	EK 46 P5V	27000	22000	19000	17000	
B-24	25x40	6x40	EK 46 P5V	22000	19000	16000	14000	
B-25	25x50	6x40	EK 46 P5V	27000	22000	19000	17000	
B-26	30x30	6x40	EK 46 P5V	26000	26000	20000	18000	
B-27	30x40	6x40	EK 46 P5V	16000	14000	11000	10000	
B-28	30x50	6x40	EK 46 P5V	19000	16000	14000	12000	
B-29	40x40	6x40	EK 46 P5V	21000	18000	15000	13000	

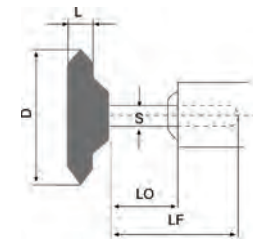

TİP 52

FORM	DxL	SxLF	Kalite	LO				
				Quality	10	15	20	25
C-1	25x8	6x40	EK 60 P5V	34000	34000	34000	34000	
C-2	32x8	6x40	EK 60 P5V	26000	26000	26000	26000	
C-3	40x10	6x40	EK 46 P5V	21000	21000	21000	21000	
C-4	50x12	6x40	EK 46 P5V	17000	17000	17000	17000	

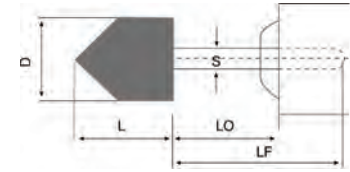

TİP 52

FORM	DxL	SxLF	Kalite	LO				
				Quality	10	15	20	25
D-1	8x20	6x40	EK 60 P5V	45000	37000	31000	28000	
D-2	10x25	6x40	EK 60 P5V	75000	63000	53000	47000	
D-3	12x20	6x40	EK 60 P5V	66000	55000	46000	41000	
D-4	16x25	6x40	EK 60 P5V	53000	47000	40000	35000	
D-5	20x35	6x40	EK 46 P5V	32000	27000	23000	20000	

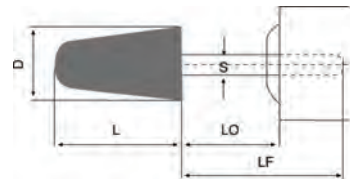

TİP 52

FORM	DxL	SxLF	Kalite	LO				
				Quality	10	15	20	25
E-1	5x5	6x40	EK 80 P5V	64000	53000	45000	40000	
E-2	5x10	6x40	EK 80 P5V	64000	53000	45000	40000	
E-3	8x16	6x40	EK 80 P5V	38000	32000	27000	24000	
E-4	8x20	6x40	EK 80 P5V	38000	32000	27000	24000	
E-5	10x20	6x40	EK 60 P5V	32000	27000	23000	20000	
E-6	10x30	6x40	EK 60 P5V	57000	48000	40000	36000	
E-7	12x25	6x40	EK 60 P5V	53000	47000	40000	35000	
E-8	12x30	6x40	EK 60 P5V	53000	53000	53000	53000	
E-9	12x40	6x40	EK 60 P5V	37000	31000	26000	23000	
E-10	16x16	6x40	EK 46 P5V	29000	24000	20000	18000	
E-11	16x32	6x40	EK 46 P5V	42000	35000	29000	26000	
E-12	16x40	6x40	EK 46 P5V	28000	24000	20000	18000	
E-13	20x20	6x40	EK 46 P5V	43000	43000	36000	32000	
E-14	20x30	6x40	EK 46 P5V	32000	27000	23000	20000	
E-15	20x40	6x40	EK 46 P5V	43000	36000	30000	27000	
E-16	25x25	6x40	EK 46 P5V	34000	34000	34000	34000	
E-17	25x32	6x40	EK 46 P5V	26000	22000	38000	16000	
E-18	25x40	6x40	EK 46 P5V	34000	28000	24000	21000	
E-19	32x32	6x40	EK 46 P5V	26000	26000	20000	18000	
E-20	32x40	6x40	EK 46 P5V	26000	21000	17000	15000	
E-21	32x50	6x40	EK 46 P5V	19000	16000	14000	12000	

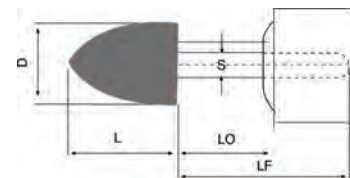

TİP 52

FORM	DxL	SxLF	Kalite	LO				
				Quality	10	15	20	25
F-1	8x16	6x40	EK 60 P5V	38000	32000	27000	24000	
F-2	13x20	6x40	EK 60 P5V	66000	55000	66000	41000	
F-3	20x32	6x40	EK 46 P5V	32000	27000	23000	20000	
F-4	20x40	6x40	EK 46 P5V	28000	24000	20000	18000	

Not: Renk verilmiş yerler taşıyıcı ideal çalışma şartlarını gösterir.
 Note: The coloured columns indicate the ideal working conditions of the wheel.
 P.S.: Die farbigen Spalten zeigen die idealen Arbeitsbedingungen des Rades